

**COMUNE DI VILLAGRANCA TIRRENA
CITTA' METROPOLITANA DI MESSINA**

Progetto: "Progetto di una cappella funeraria privata di nuova costruzione, inserita all'interno dell'area cimiteriale Divieto - Serro - censita al N.C.E.U. del Comune di Villafranca Tirrena al foglio 4, particella 1092"

Committente : Domenico La Rosa - Anna De Luca



Elaborato n° 1 : Inquadramento territoriale scala 1:2000: ortofoto, stralcio aerofotogrammetrico, stralcio catastale, stralcio Piano Paesaggistico Ambito 9, stralcio Natura 2000_ZPS

Progettista: Urban Future Organization s.r.l.
D. T. Arch. Francesco Giordano

urban future organization srl
diramazione viaria a zona industriale
98040 gianmoro_pace del mela me
tel. 090 9335766 fax 090 9375136
partita Iva. 02836460838

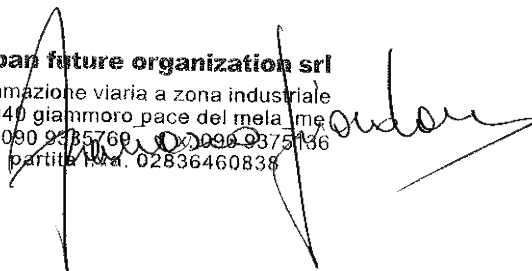

Data: Pace del Mela, 14 Febbraio 2025



Immagini satellitari

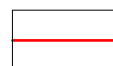

area oggetto di intervento

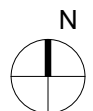
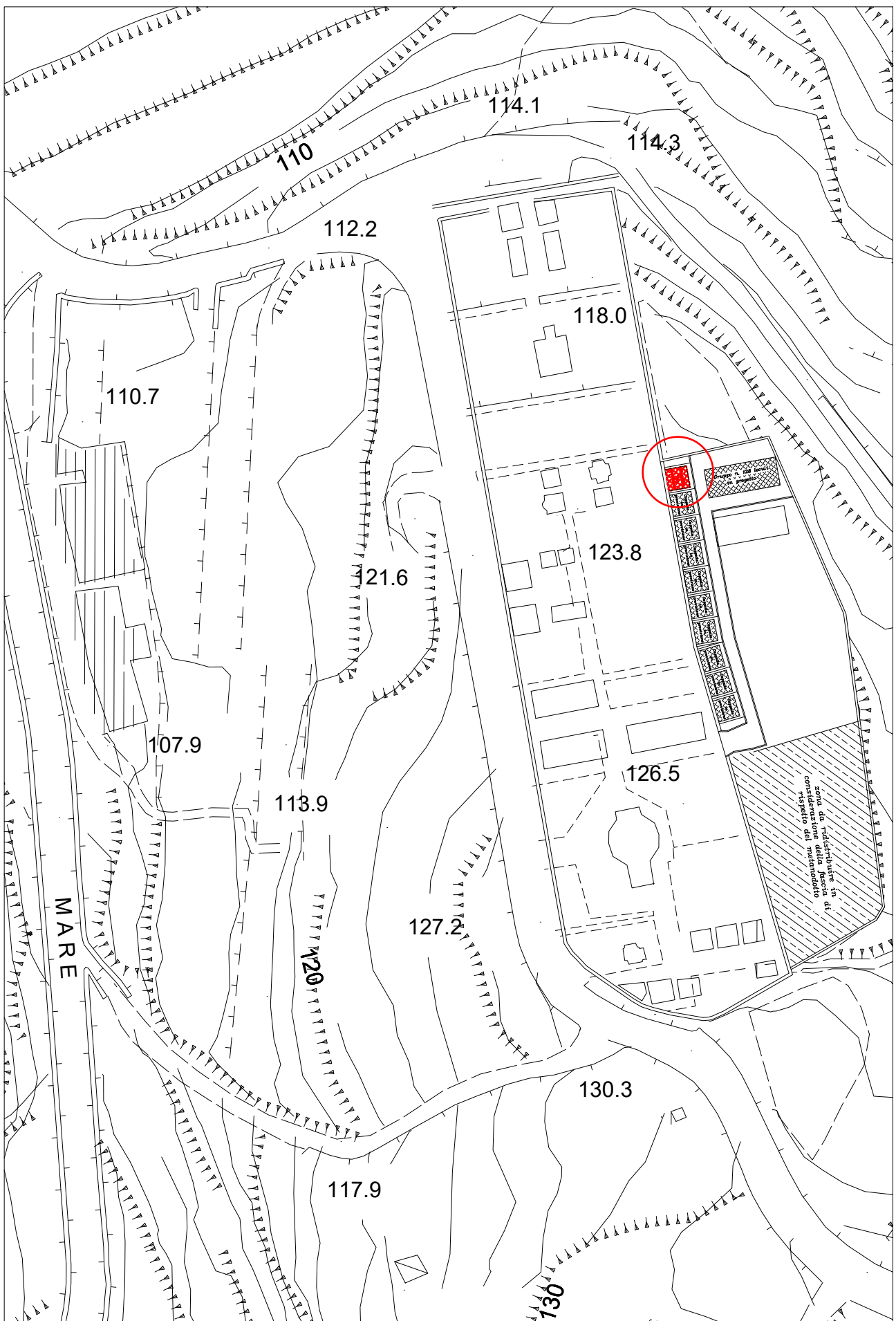

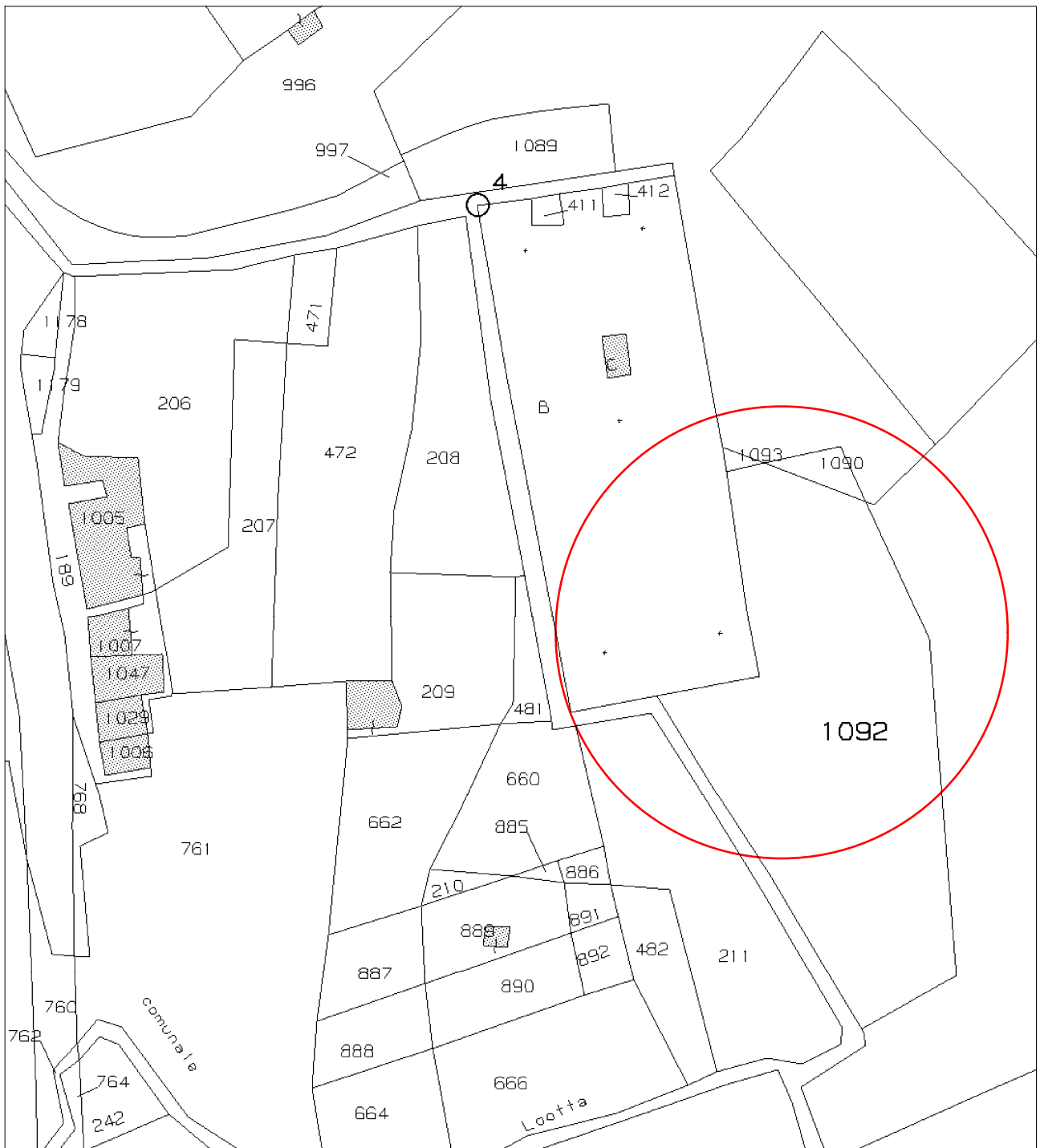

 Area oggetto dell' intervento

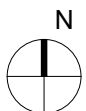

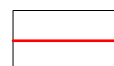



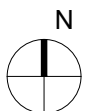



Area oggetto dell' intervento





-  Area oggetto dell' intervento
-  SIC/ZPS
-  ZSC/ZPS
-  ZPS
-  ZSC
-  SIC

Natura 2000_Zona di Protezione Speciale (ZPS)
ITA030042 "Monti Peloritani, Dorsale Curcuraci,
Antennamare e area marina dello stretto di Messina"
Scala 1:2000

